

This guide applies to the following versions of the Gulley drain

<p>Vinyl floor gulley - Horizontal outlet</p> <p>Part no. UTVG01/H</p>	<p>Vinyl floor gulley - Vertical outlet</p> <p>Part no. UTVG01/V</p>	<p>Vinyl floor gulley - Horizontal outlet - Chrome</p> <p>Part no. UTVC01/H</p>	<p>Vinyl floor gulley - Vertical outlet - Chrome</p> <p>Part no. UTVC01/V</p>
--	--	---	---

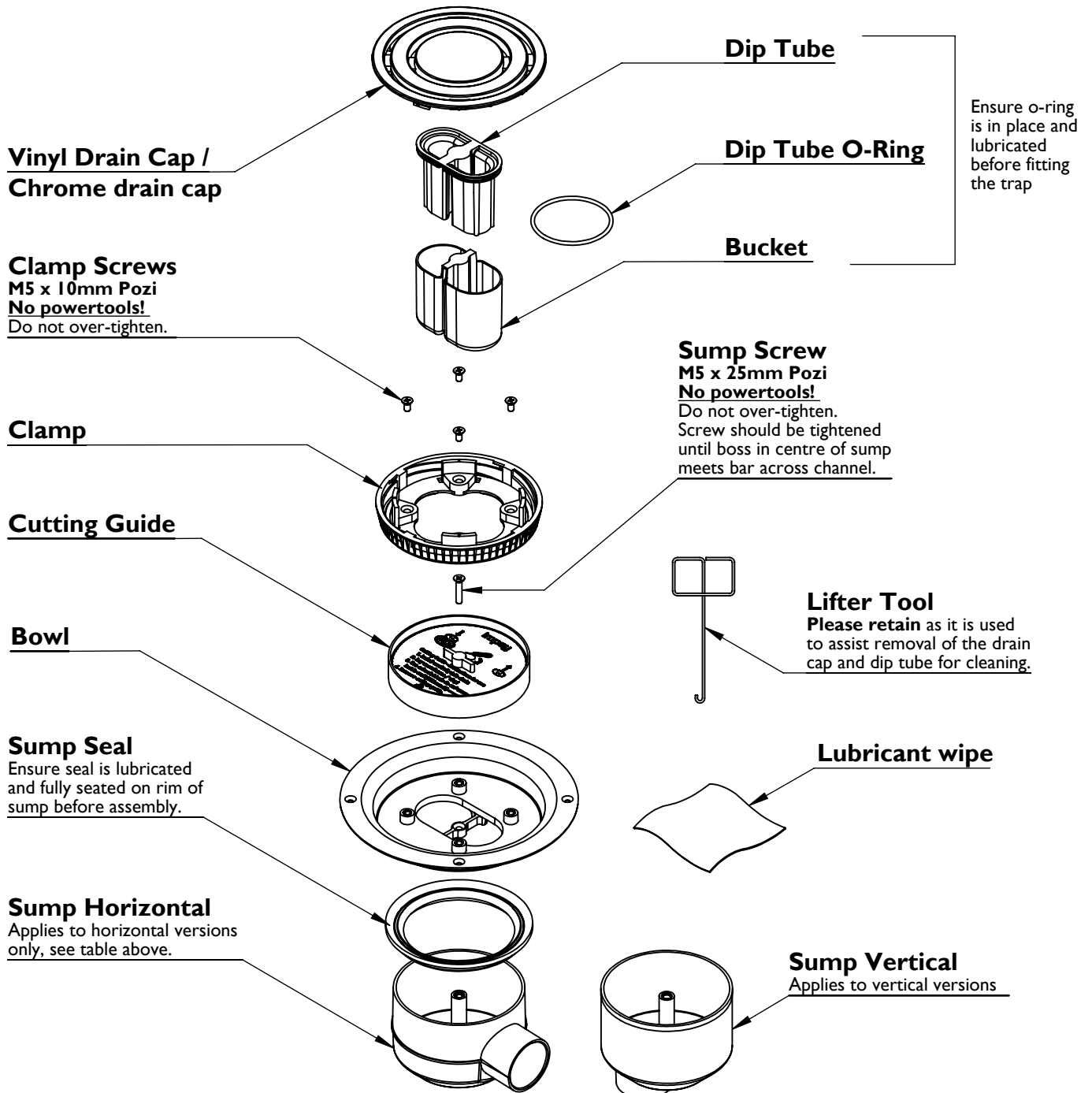

Safety

Please read these installation instructions carefully before proceeding.
 Keep guide for future reference.
 Incorrect installation will invalidate the guarantee.
 Make sure there are no hidden pipes or cables in the floor or walls where you intend to drill.
 Use appropriate personal protective equipment.

Installation details

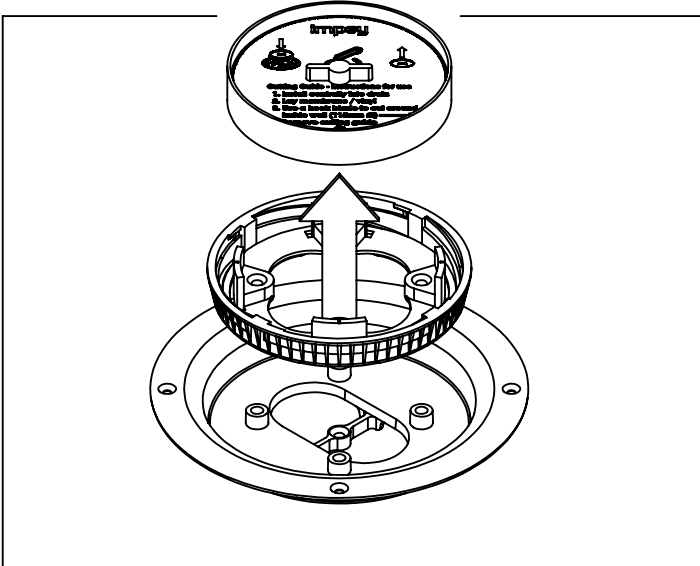

1. Separate cutting guide and clamp from bowl
It is important to make sure the clamp is removed before laying any floor covering.

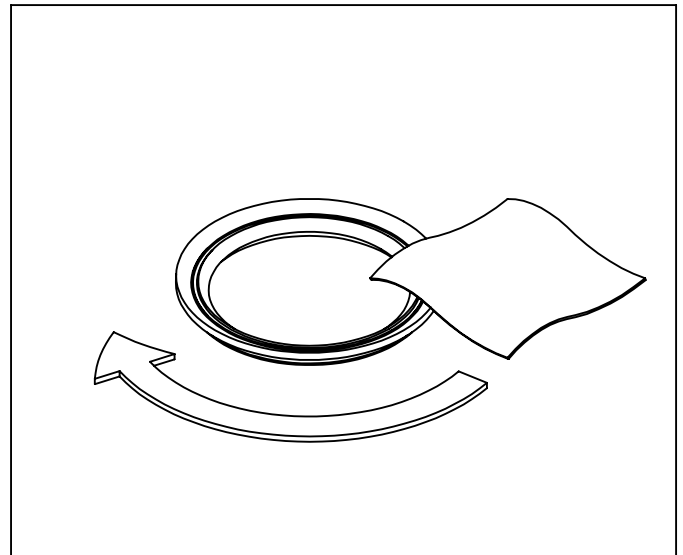

2. Apply lubricant to seal
Before fitting the sump and bowl together, it is vital to lubricate the rubber seal with the silicone wipe provided.

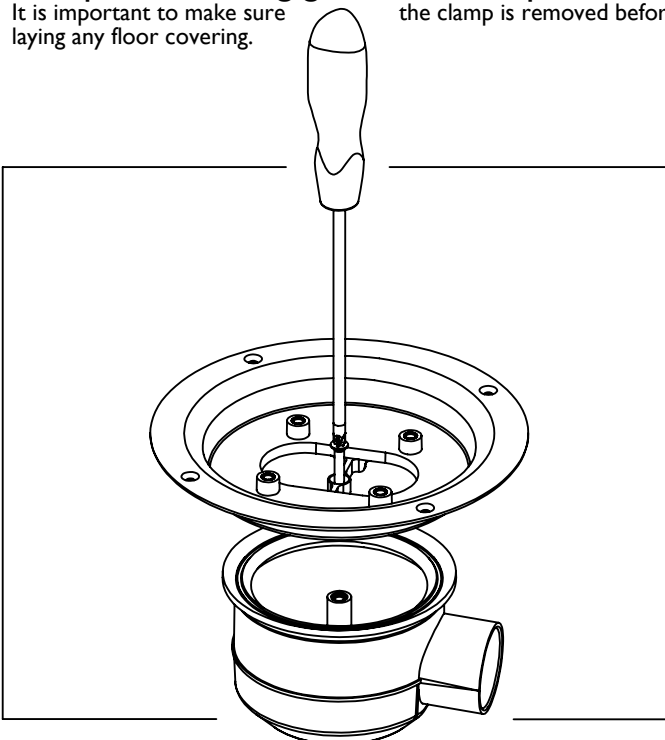

3. Fit the sump
Ensure the seal is positioned on the rim of the sump and fully pushed into place. Align the bowl and sump, then fit the 25mm screw through the bowl cross bar. Tighten the screw by hand until the cross bar meets with the boss in the centre of the sump.
DO NOT OVER-TIGHTEN

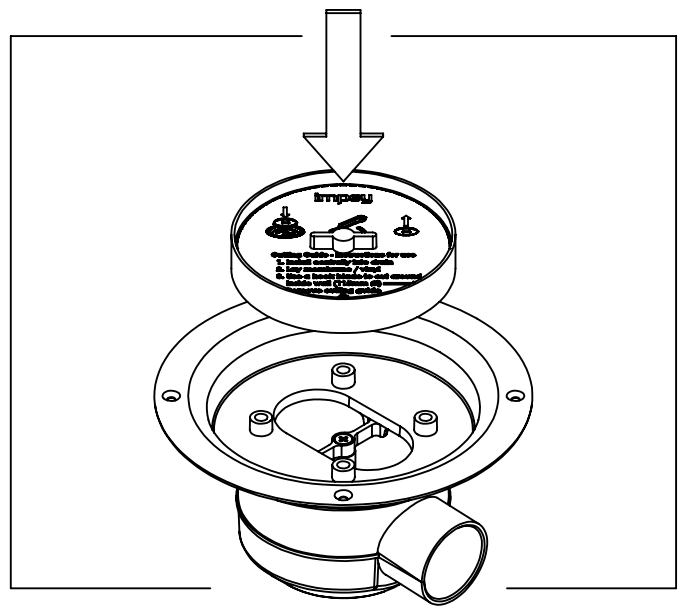

4. Install cutting guide
After Dec and bowl are fixed in place, install the cutting guide into the bowl. Ensure the cutting guide sits centrally and flush with the bowl. Cutting guide should be left in place to act as a debris shield until the vinyl is laid.

Installation details

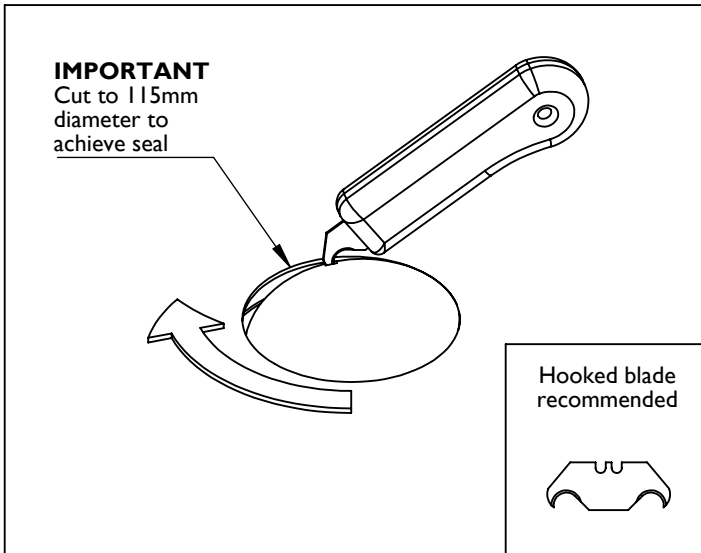

5. Cut flooring

After laying vinyl over the top of the cutting guide, cut around the inside wall of the guide using a hooked blade. Ensure cut is concentric with drain and 115mm in diameter.

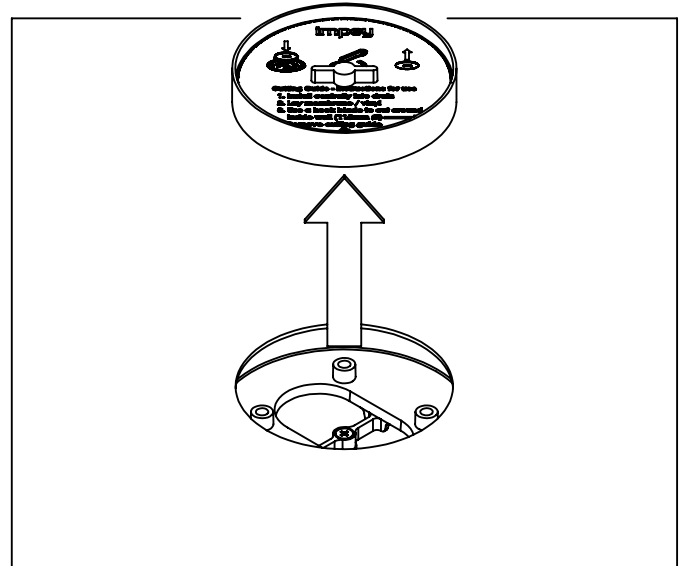

6. Remove cutting guide

Ease the cutting guide through the hole in the vinyl and continue with installation.

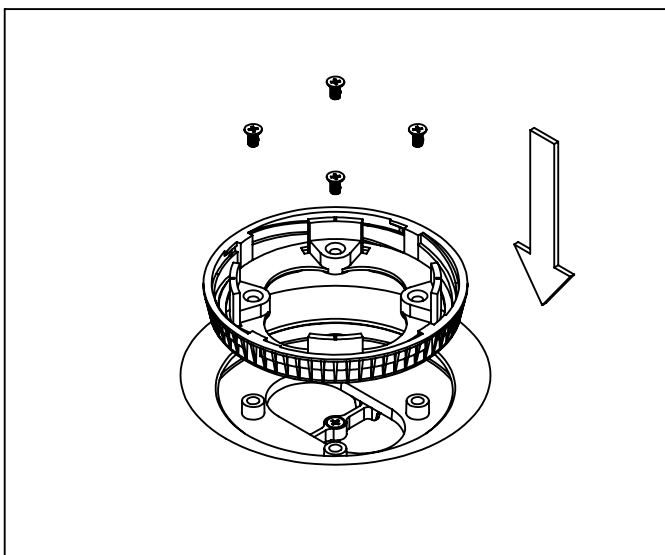

7. Install the clamp

Vinyl flooring needs to be heated with a hot air gun until soft, then the vinyl clamp can be gently pressed into place. After heating, ensure the clamp is aligned with the screw bosses on the bowl and gradually ease the clamp into place until fully down. Now tighten the four clamp screws by hand.

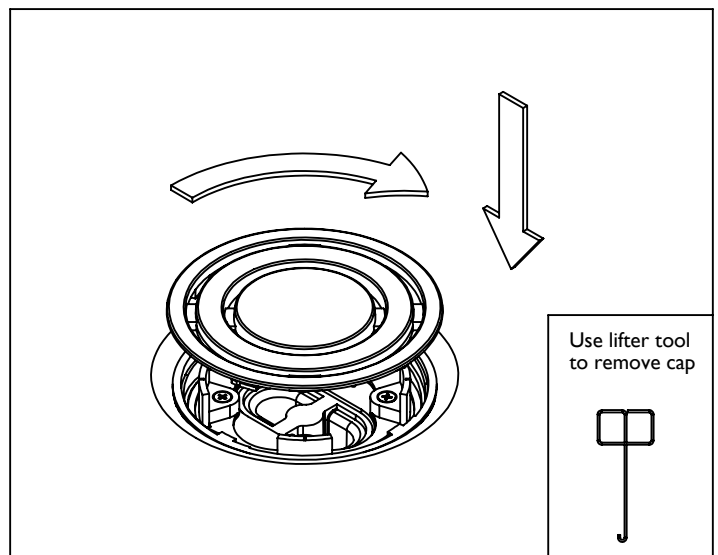

8. Fit the drain cap

The drain cap has a twist-lock mechanism. Align the cap centrally to the drain, then press and twist clockwise to snap it into place. To remove for cleaning, twist anti-clockwise or pull upward with the lifter tool.

Cleaning guide

It is important to periodically inspect and clean the drain, and refill the trap with water. Failure to do this is likely to result in poor flow rate and unpleasant smells.

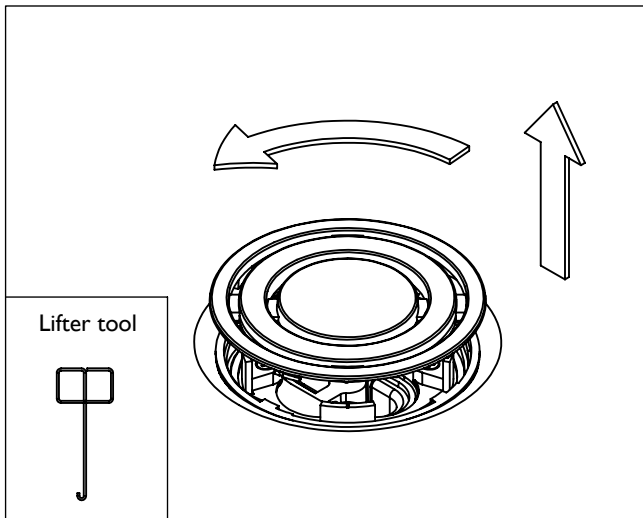

1. Remove the cover cap

Turn the cap anti-clockwise, or use the hook provided to pull gently upwards to release. This will expose the trap's dip tube.

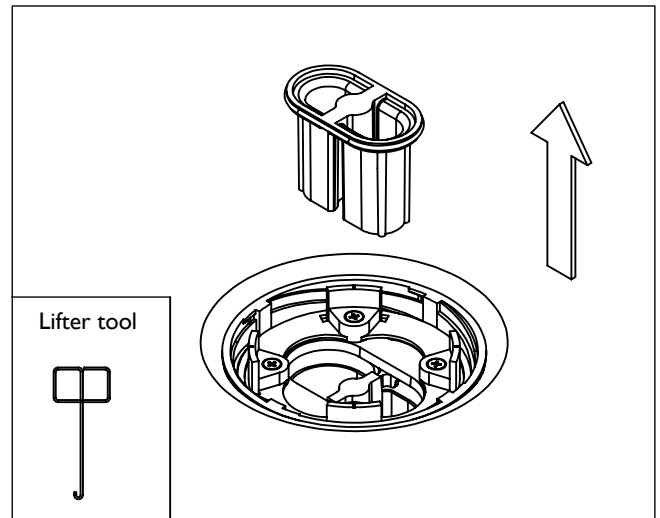

2. Remove the dip tube

Remove the dip tube from the gulley, this will expose the bucket. Slight resistance may be felt as the seal releases.

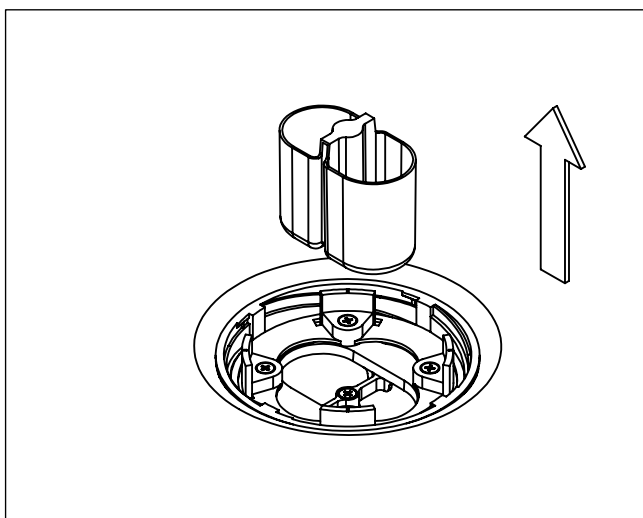

3. Remove the bucket and clean

Remove the bucket from the drain. Clean the bucket by first removing any debris and placing in a bin, then thoroughly rinse out with water until the bucket is clean. Rinse the dip tube and ensure the o-ring is also clean. The o-ring can be removed and rinsed separately if needed.

Ensure the o-ring is reinstalled

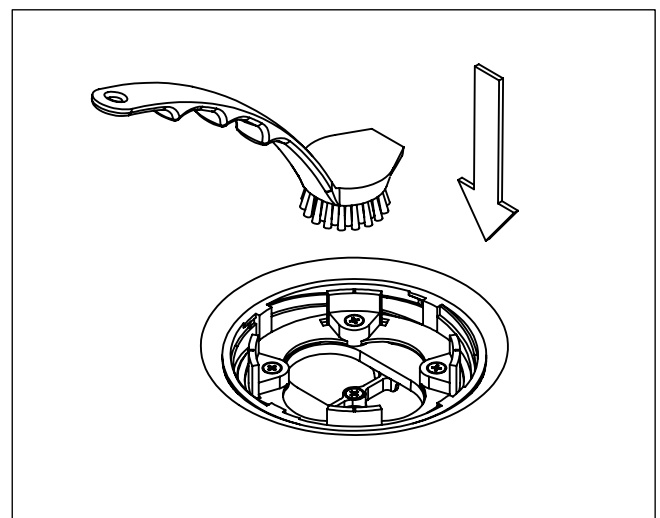

4. Clean the sump

Remove any debris from the bottom of the sump. When the sump is clear of any visible debris, pour some fresh water down to flush it through.

5. Extra cleaning

If the trap components are very dirty, a weak mixture of bleach and water can be used*. Allow the parts to soak in the mixture for five minutes, then flush through with clean water until bleach has been completely rinsed.

***Use of aggressive disinfectants/detergents or drain cleaners may cause damage to the gulley.**

6. Re-installation

Replace the bucket and dip tube and make sure the o-ring seal is in place between the dip tube and gulley. Replace the cover and turn clockwise to lock. Fill the trap with water.